



HEATING AND CONTROL
TECHNOLOGY



thermowatt.com

MyThermowatt APP

TMEC3E Wi-Fi Quick Guide (April 30th, 2026)

Table of contents

- MyThermowatt download
- Account creation and configuration
- Water heater configuration
- Main features
- Notifications
- Consumption monitoring

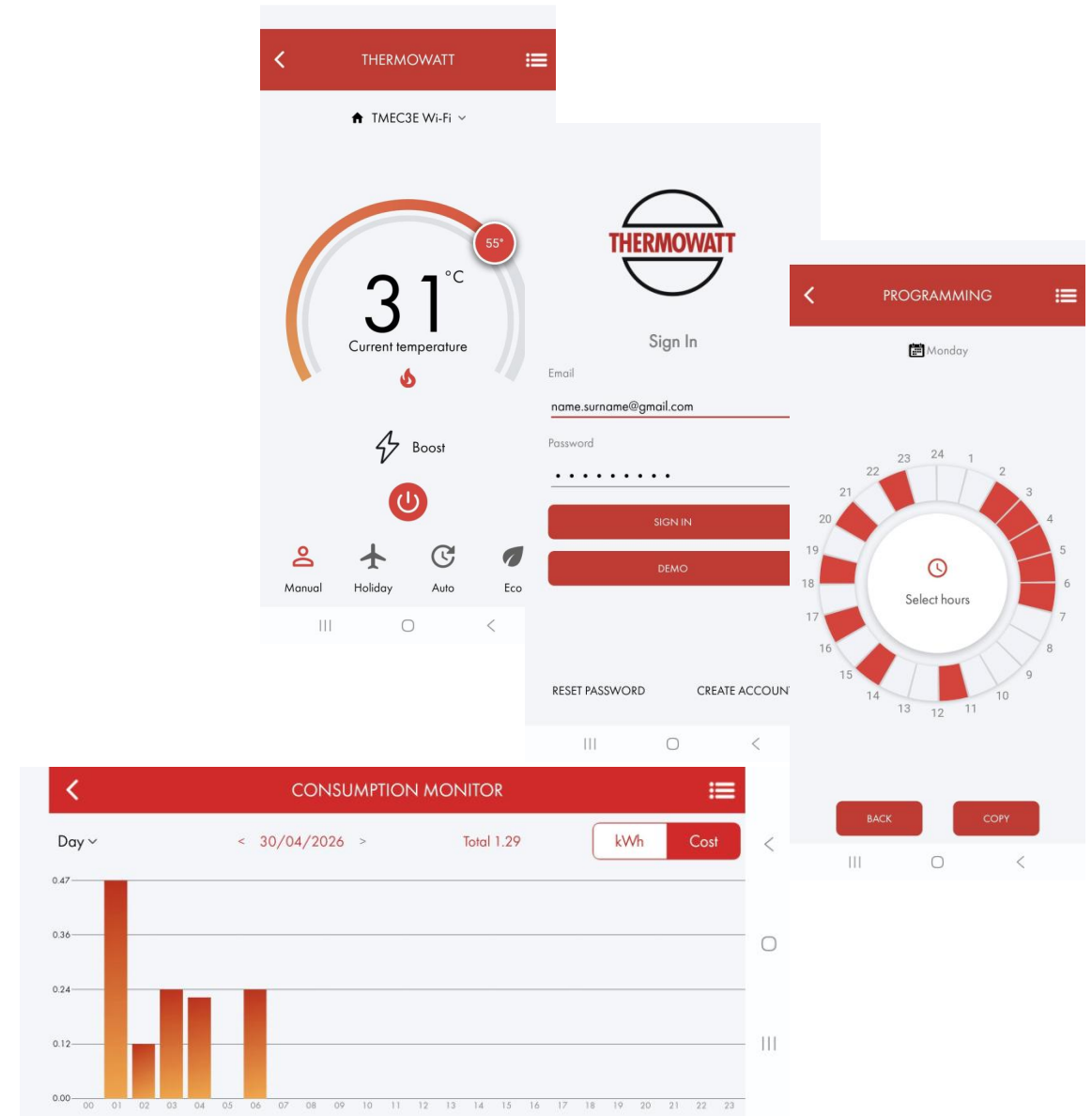

MyThermowatt download

MyThermowatt APP is available on Google Play / Apple Store for downloading on your phone or tablet

Access to the Google Play
or Apple Store with your
Google / iOS account



Download the
application



Account creation and configuration

You can create your personal account on the SIGN IN page

Click on “CREATE ACCOUNT”



Fill-in all the boxes and click on “CREATE ACCOUNT”; you will receive an email



Click on the link in the received email to activate the account; you will be redirected to the webpage confirming the successful activation



Fill-in the “Email” and “Password” boxes and click on “SIGN IN”



Sign In

Email



Password

SIGN IN

DEMO

RESET PASSWORD

CREATE ACCOUNT



CREATE ACCOUNT

Email

Password

Confirm password



I have read and accept

- ☐ Terms and Conditions*
- ☐ Privacy Notice*

I give express consent to the processing of my personal data for the purposes of profiling activities

I give express consent to the processing of my personal data for the commercial/marketing purposes

CREATE ACCOUNT



Sign In

Email

name.surname@gmail.com

Password

SIGN IN

DEMO

RESET PASSWORD

CREATE ACCOUNT



Water heater configuration

Your first water heater configuration is required when you sign in for the first time

Click on “New configuration”

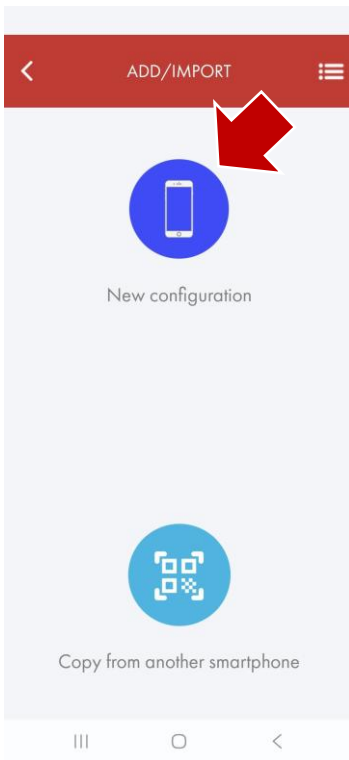

▶ Connect for the first time or disconnect/connect the TMEC3E Wi-Fi to the mains supply via the external circuit breaker; the Wi-Fi blue LED starts blinking for 5 minutes

Note: Ensure that there is water in the system before the TMEC3E Wi-Fi is connected to the mains supply



▶ Enable localization and Bluetooth on your device, if required

▶ Fill-in all the boxes and click on “CONNECTION TO THE WATER HEATER”; you will be redirected to the HOME page (*)

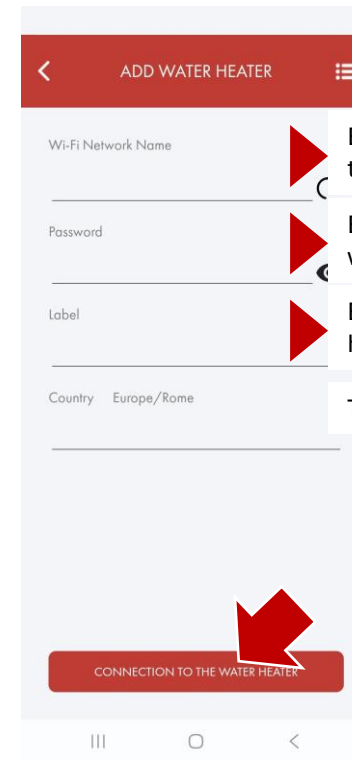
A screenshot of a mobile application interface for adding a water heater. It features a red header bar with a back arrow, the text 'ADD WATER HEATER', and a menu icon. Below the header, there are four input fields: 'Wi-Fi Network Name', 'Password', 'Label', and 'Country'. The 'Country' field is pre-filled with 'Europe/Rome'. At the bottom, there is a red button with the text 'CONNECTION TO THE WATER HEATER'. A large red arrow points from the bottom right towards this button.

▶ Enter the name of the Wi-Fi network to which the water heater has to be connected

▶ Enter the password of the Wi-Fi network to which the water heater has to be connected

▶ Enter the name you wish to identify the water heater

The Country is automatically detected

(*) If a connection error occurs, repeat the procedure and check the info in “Wi-Fi Network Name” and “Password” boxes before clicking on “CONNECTION TO THE WATER HEATER” again

Water heater configuration

You can control more than one water heater with your MyThermowatt account

Click on the dropdown menu and click on “MANAGE WATER HEATER”



Click on “Add water heater”



Repeat the procedure already described for the first water heater configuration

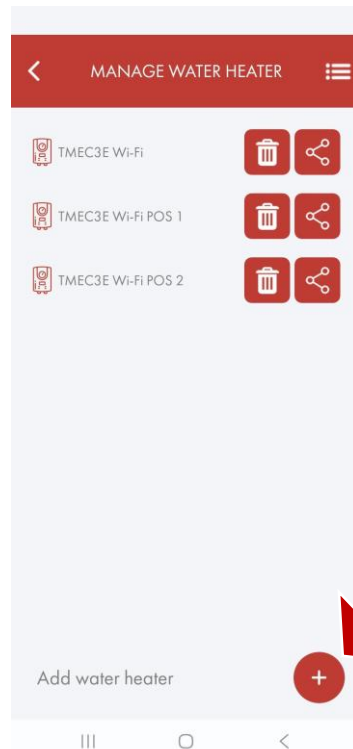
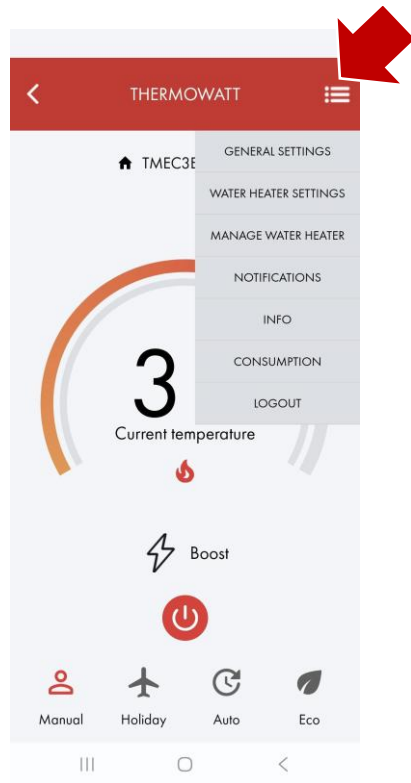

Click on “New configuration”



Connect for the first time or disconnect/connect the TMEC3E Wi-Fi to the mains supply via the external circuit breaker; the Wi-Fi blue LED starts blinking for 5 minutes



Enable localization and Bluetooth on your device, if required



Fill-in all the boxes and click on “CONNECTION TO THE WATER HEATER”; you will be redirected to the HOME page (*)

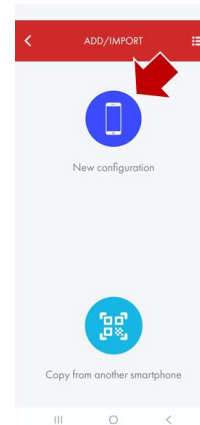

Note: Ensure that there is water in the system before the TMEC3E Wi-Fi is switched on.

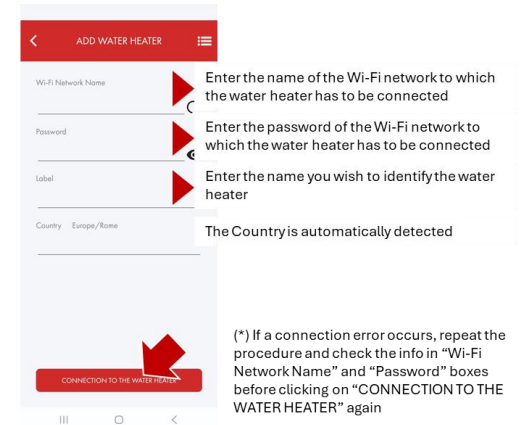

Water heater configuration

You can control the same water heater with more than one MyThermowatt account

Click on the dropdown menu and click on “MANAGE WATER HEATER”

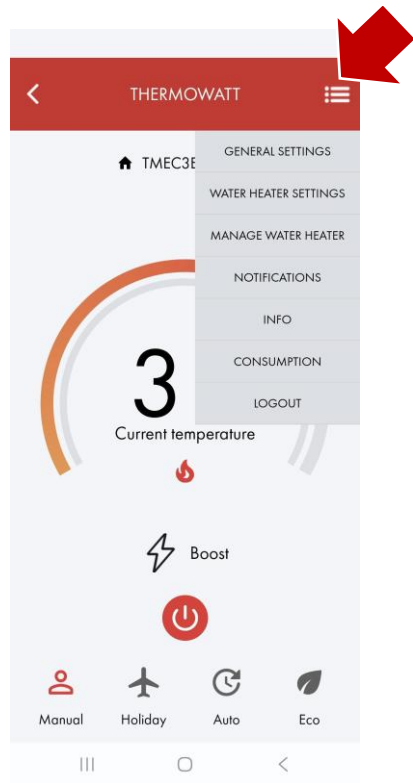

1st MyThermowatt account:
click on share icon
2nd MyThermowatt account:
click on “Add water heater”

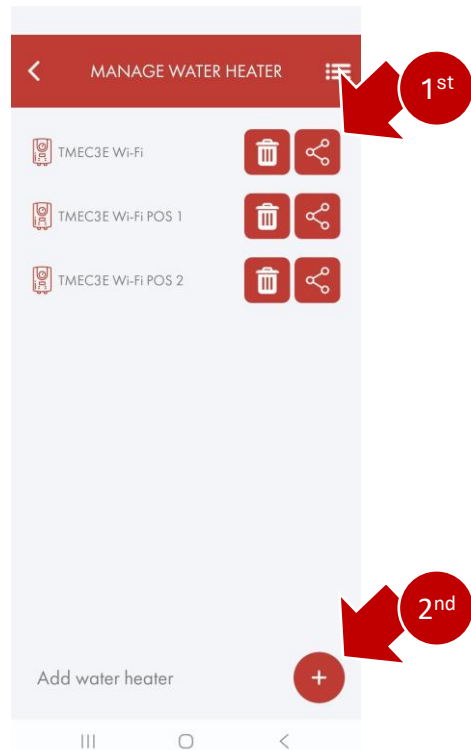

2nd MyThermowatt account: click on “Copy from another smartphone” and scan the QR Code generated from the 1st MyThermowatt account

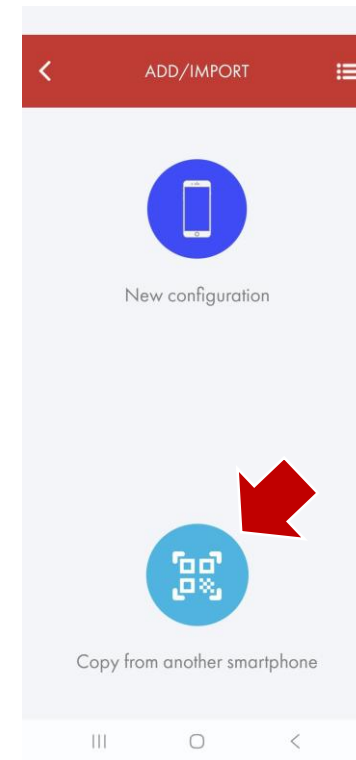

Main features

HOME page: you can select temperature setpoint / working mode and get info from your water heater

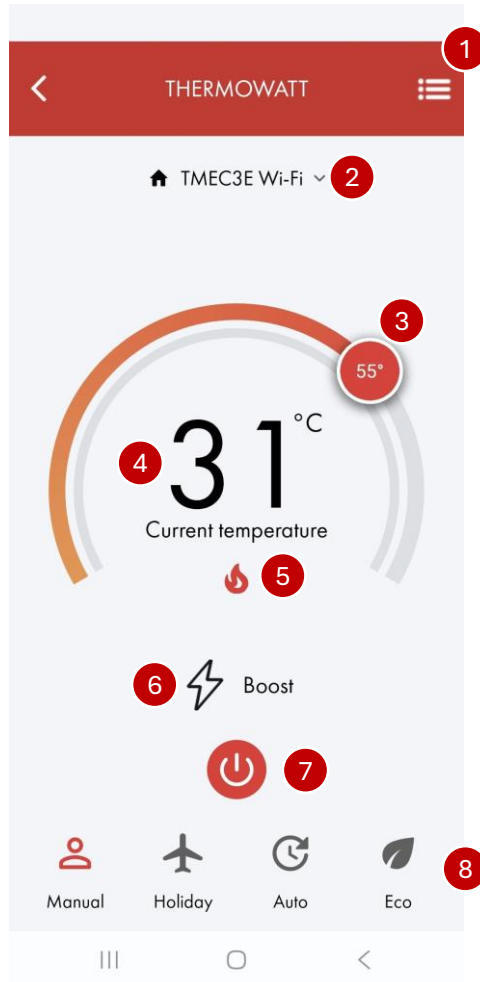

1- DROPDOWN MENU: you can enter the menu to manage settings, water heaters and info

2- SELECTED WATER HEATER: you can select from the dropdown menu which of your water heaters you would like to control

3- TEMPERATURE SETPOINT: you can adjust the temperature setpoint moving the red balloon on the grey area

4- CURRENT TEMPERATURE: the water temperature currently measured inside your water heater

5- HEATING ELEMENT STATUS: red flame when the heating element is switched on and grey flame when the heating element is switched off

6- BOOST ICON: you can activate/deactivate the temporary function (red flash when the function is activated and grey flash when the function is deactivated)

7- ON/OFF ICON: you can switch ON/OFF your water heater (red icon when the water heater is switched on and grey icon when the water heater is switched off)

8- WORKING MODES: you can select which working mode you would like to set (the red icon identifies the working mode currently set)

Main features

General settings

Click on the dropdown menu and click on “GENERAL SETTINGS”



Select your preferences (red colored)

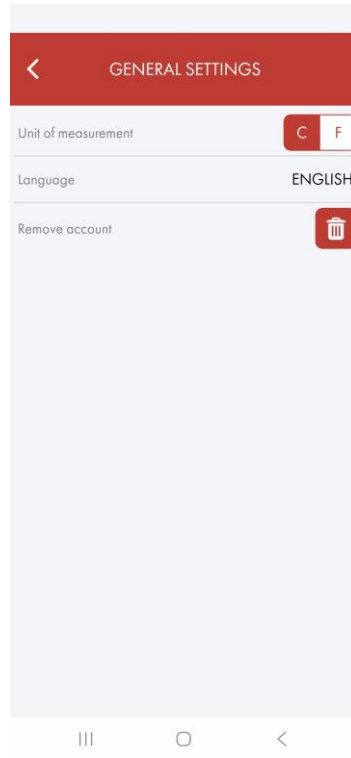
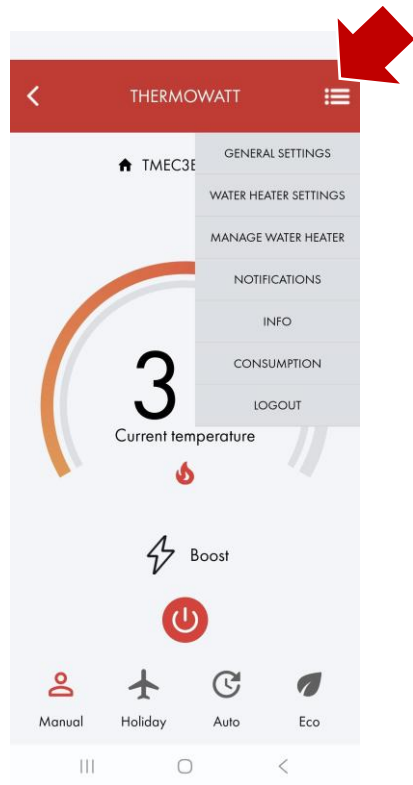

Main features

Water heater settings (related to the currently selected water heater, only)

Click on the dropdown menu and click on “WATER HEATER SETTINGS”



Select your preferences (red colored)

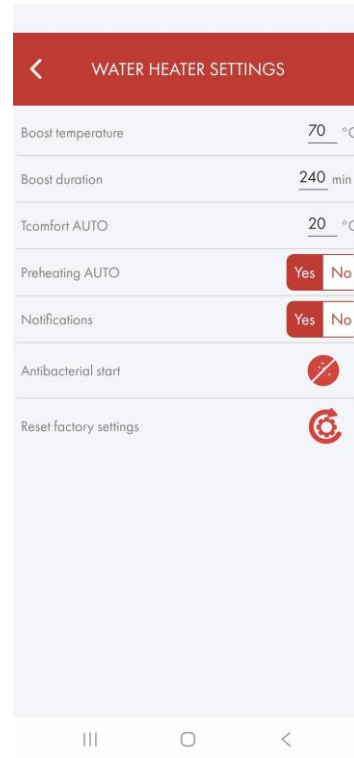
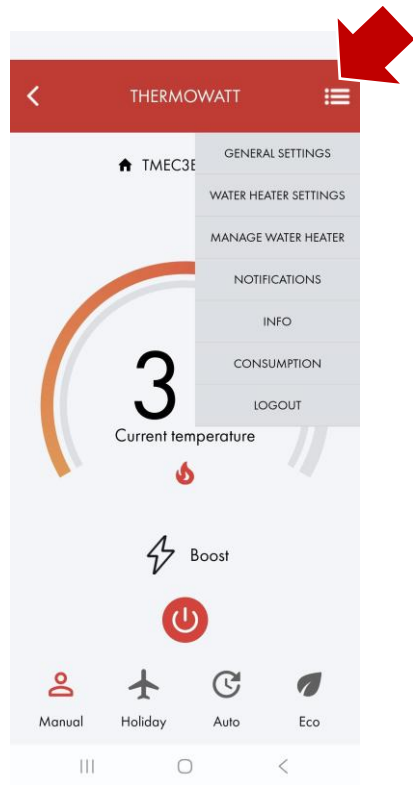

Main features

Working modes: MANUAL

Click on the “Manual” icon



Adjust the temperature setpoint moving the red balloon on the grey area

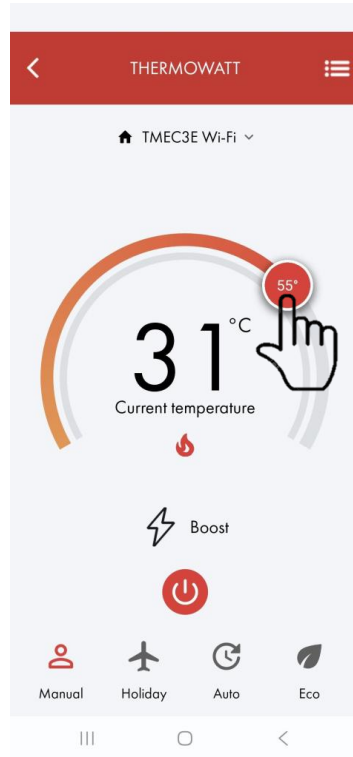
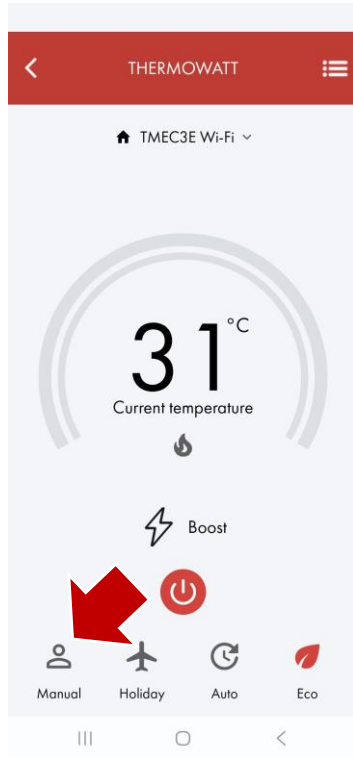

Main features

Working modes: HOLIDAY

Click on the “Holiday” icon to switch off temporarily the water heater



Select the date when the water heater will be switched on again (returning in the previously selected working mode) and click on “DONE”

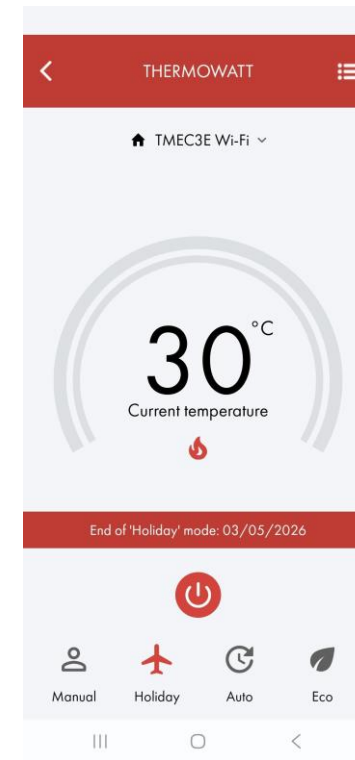
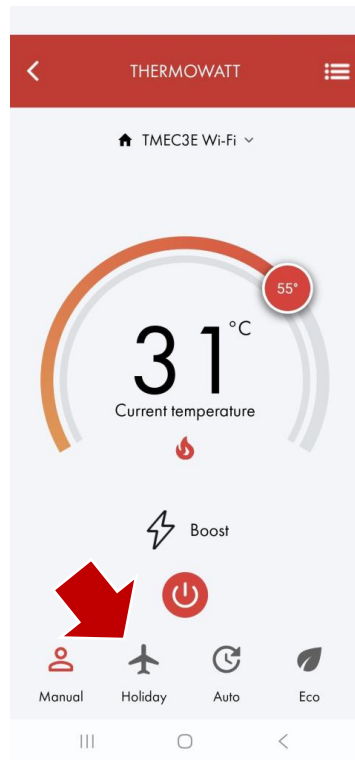

Main features

Working modes: AUTO / PROGRAMMING with TIMER algorithm

Click on the “Auto” icon to set the weekly programming

▶ Select the day of the week and the hours (red colored) when the heating element switches on to let the measured temperature inside the water heater reach the temperature setpoint

▶ Copy the schedule (click on “COPY”) or repeat the previous step (click on “BACK”) for each day of the week

▶ Click on “SAVE” and adjust the temperature setpoint moving the red balloon on the grey area

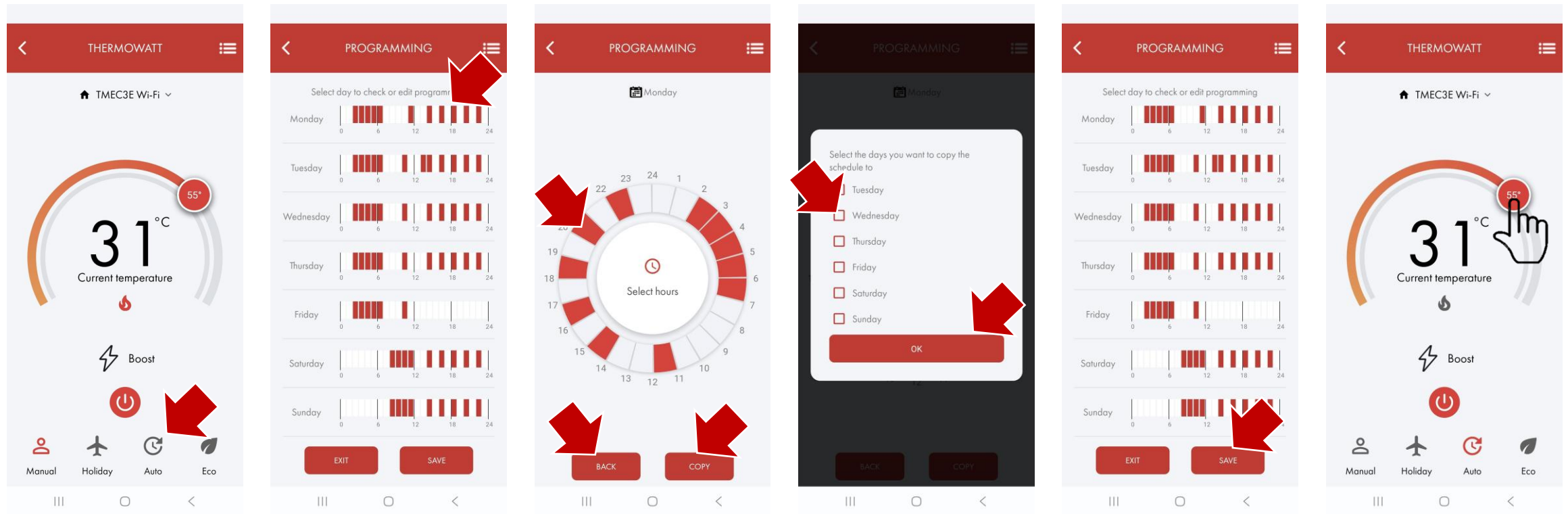

Main features

Working modes: AUTO / PROGRAMMING with TIMER algorithm

AUTO MODE with TIMER algorithm is the working mode tailor-designed to end users who want to get maximum control

The end user sets the period in which the heating element can switch on to reach the temperature setpoint (*)

TIMER algorithm guarantees always a minimum level of comfort decided by the end user through to the $T_{COMFORT}$ setting (click on the dropdown menu → click on “WATER HEATER SETTINGS” → fill in the “Tcomfort AUTO” box with a value $< T_{SETPOINT}$)

(*) The heating element can switch on out of set periods in case of need: e.g., current temperature $< T_{COMFORT}$ AUTO or during the antibacterial cycle

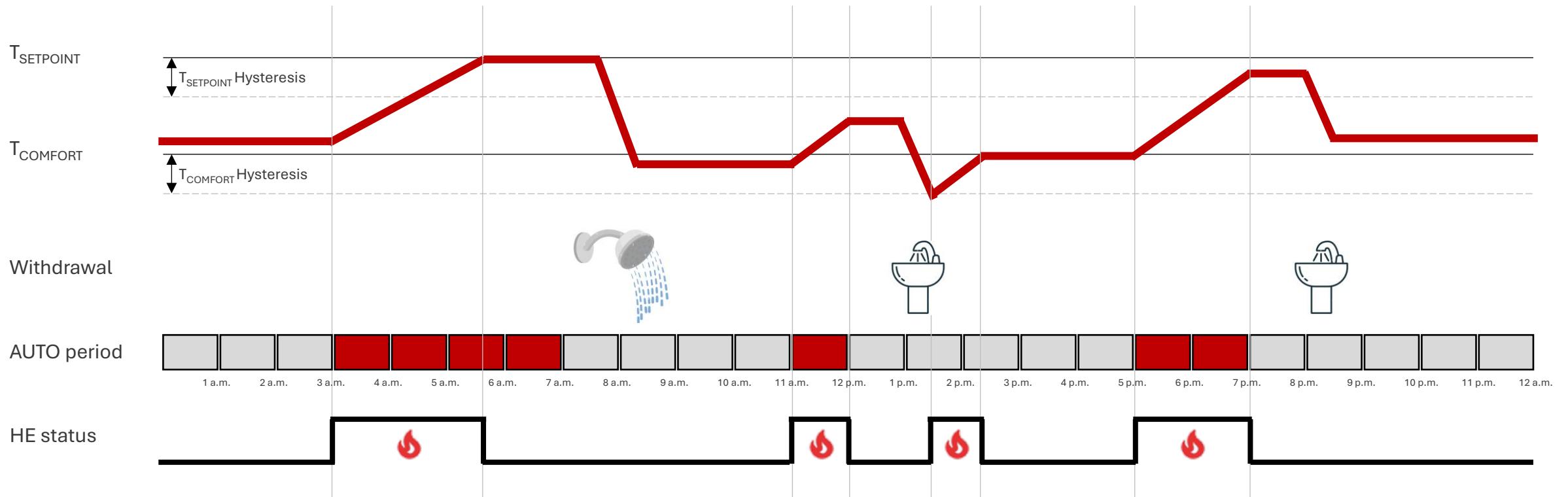

Main features

Working modes: AUTO / PROGRAMMING with TIMER algorithm and enabled PRE-HEATING

AUTO MODE with TIMER algorithm and enabled PRE-HEATING is the working mode tailor-designed to end users who want to get maximum comfort. The heating element switches on in advance to reach the temperature setpoint right at the beginning of the time slots selected by the end user. To enable the PRE-HEATING, click on the dropdown menu → click on “WATER HEATER SETTINGS” → select “Yes” next to “Preheating AUTO”. TIMER algorithm and enabled PRE-HEATING guarantee always a minimum level of comfort decided by the end user through to the $T_{COMFORT}$ setting (click on the dropdown menu → click on “WATER HEATER SETTINGS” → fill in the “Tcomfort AUTO” box with a value $< T_{SETPOINT}$).

(*) The heating element can switch on out of set periods in case of need: e.g., current temperature $< T_{comfort AUTO}$ or during the antibacterial cycle.

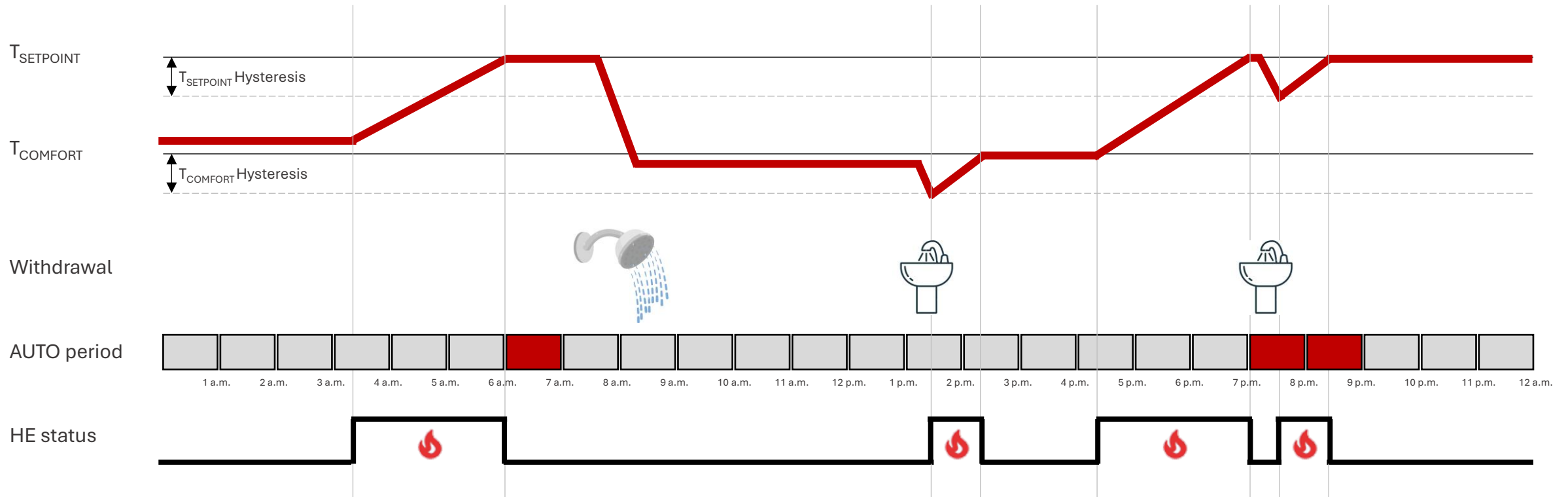

Main features

Working modes: ECO

Click on the “Eco” icon to activate the self-learning mode (*)

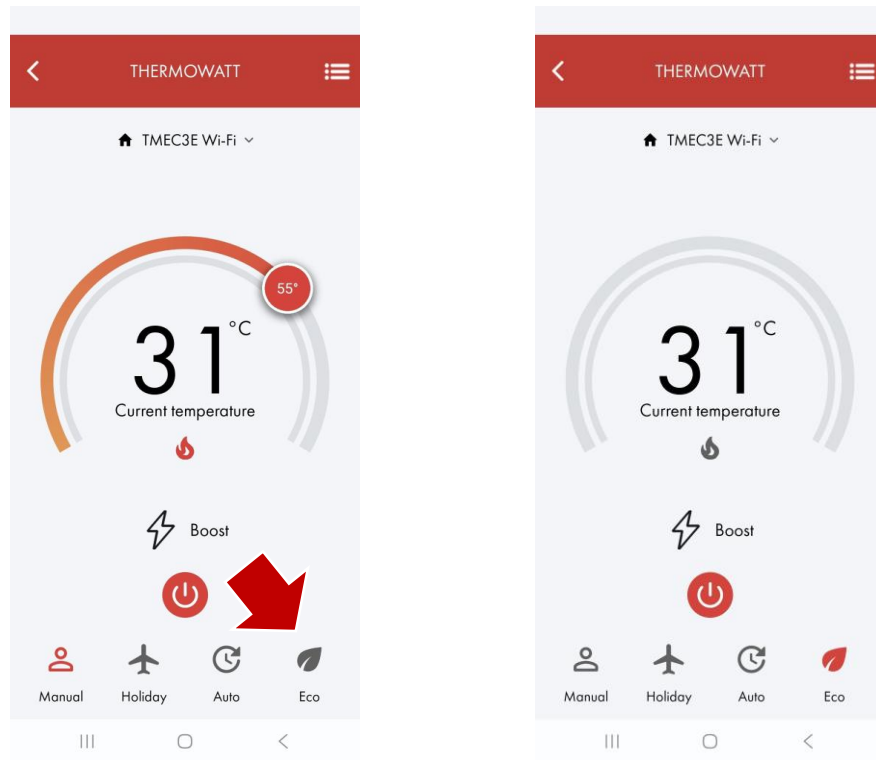

(*) The self-learning ECO mode records the end user's habits and adapts the temperature setpoint of the water heater accordingly, in terms of time and energy content, ensuring comfort at any time and increasing energy consumption efficiency

Main features

Temporary function: BOOST (*)

Click on the dropdown menu and click on “WATER HEATER SETTINGS”

Adjust the new temperature set point (“Boost temperature” > T_{SETPOINT}) and the duration (“Boost duration”) before returning to the currently selected working mode

Click on the “Boost” icon to activate (or deactivate) the function

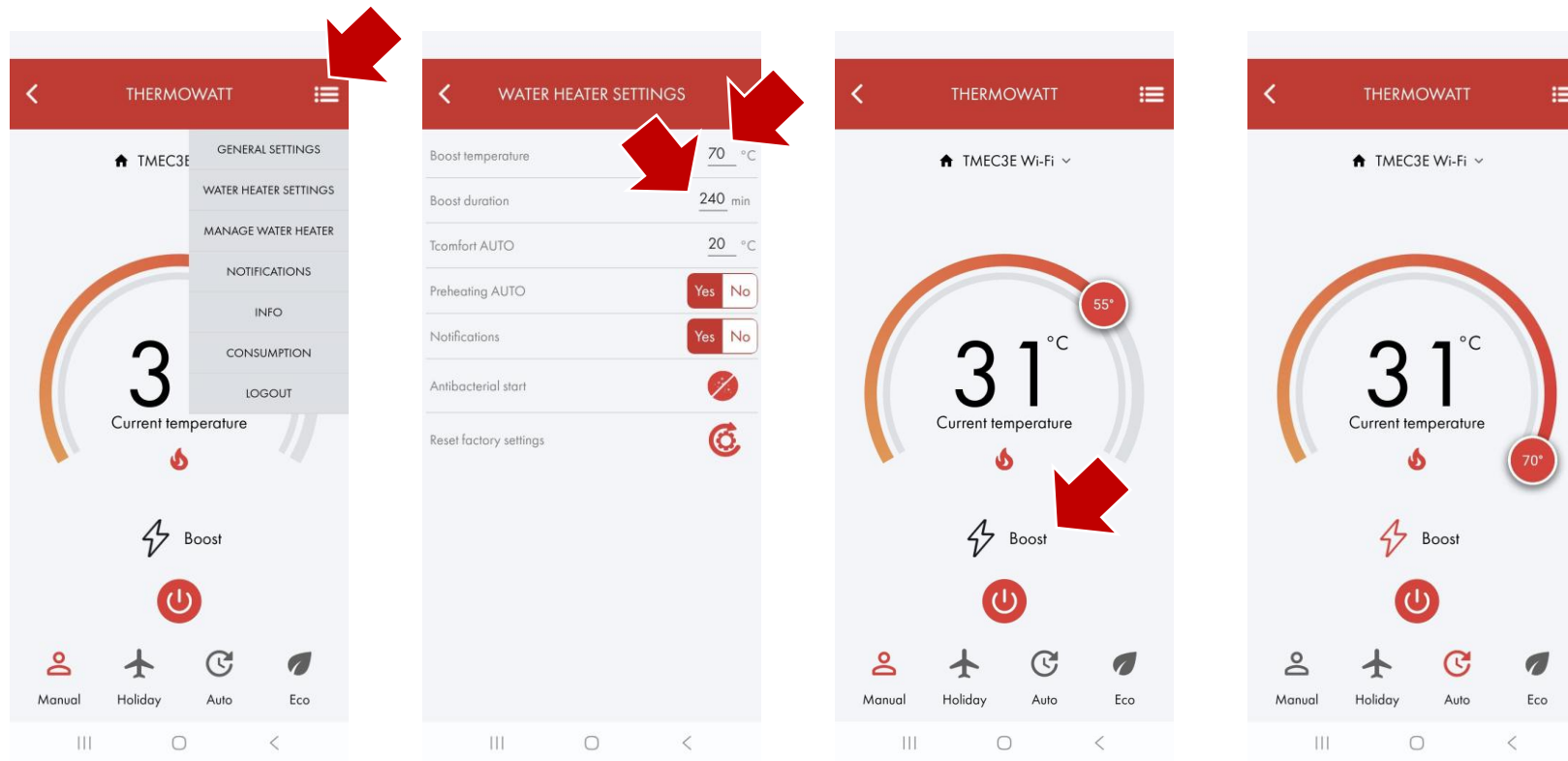

(*) The temporary BOOST function could be activated by the user only if the working mode is MANUAL or AUTO / PROGRAMMING

Notifications

MyThermowatt sends you notification in case of water heater info or malfunctioning suggesting you how to proceed (troubleshooting)

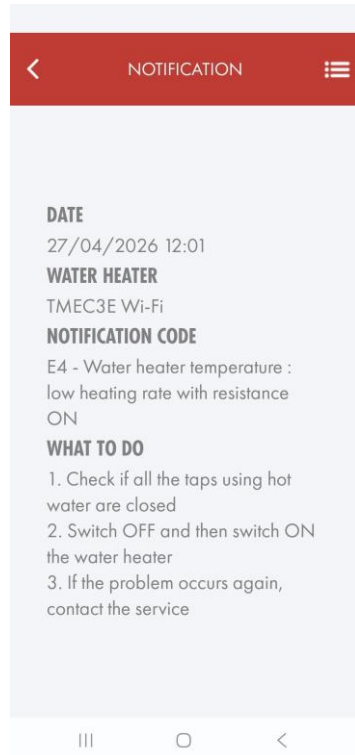

For notification history click on the dropdown menu and click on “NOTIFICATIONS”

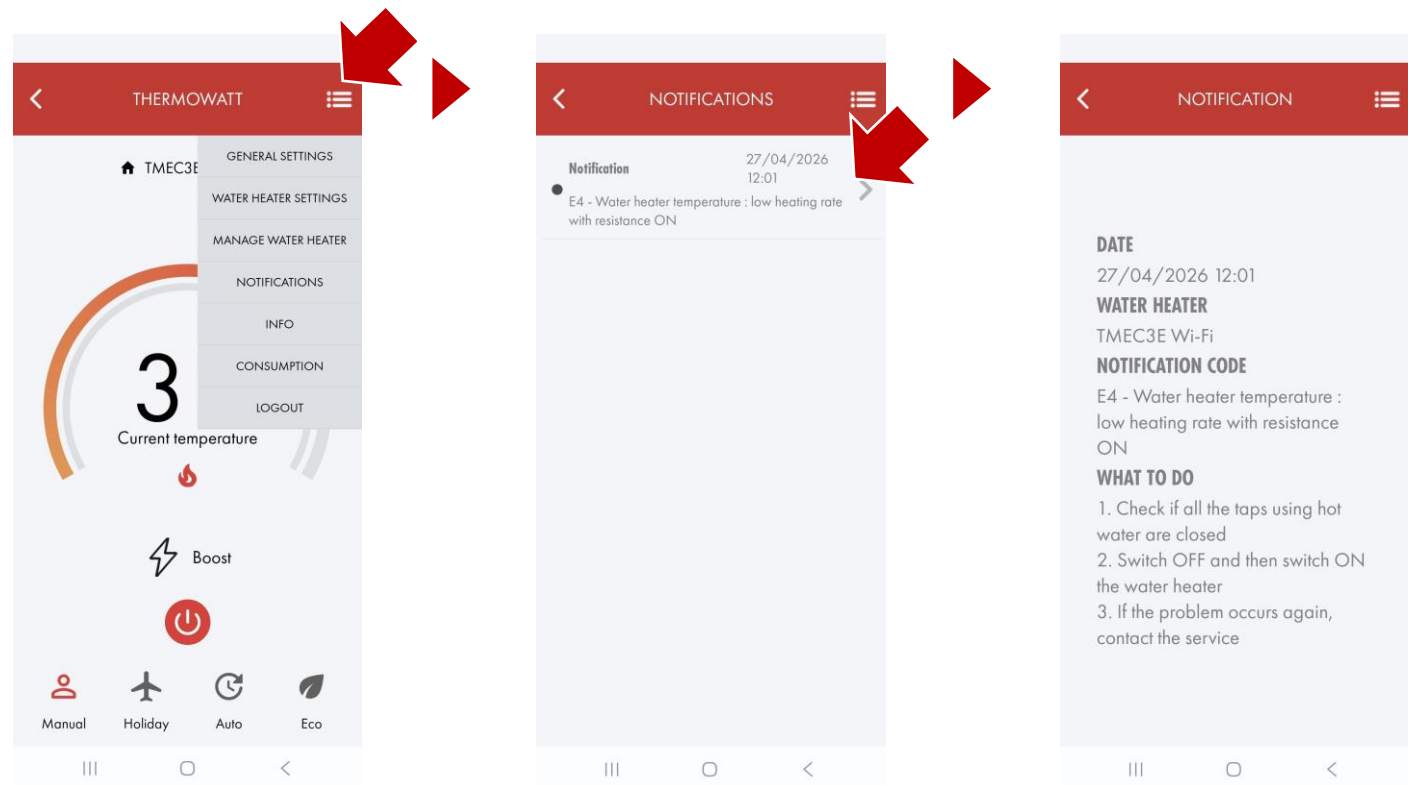

Consumption monitoring

MyThermowatt can assess the energy consumption and related cost of your water heater providing dashboards to let you increase awareness and savings

Click on the dropdown menu and click on “CONSUMPTION”

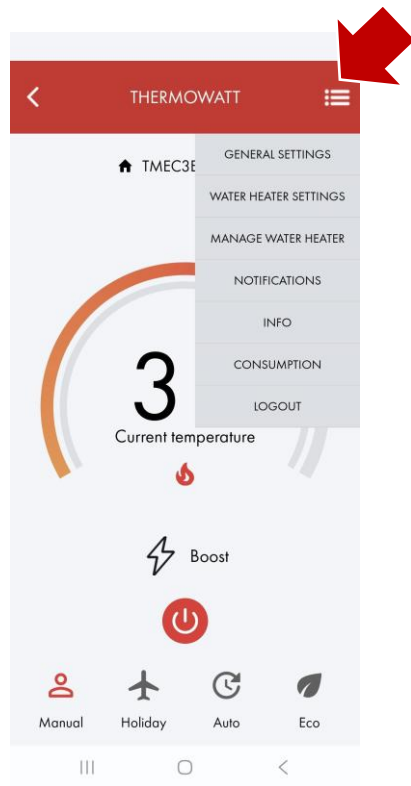

Fill-in all the boxes

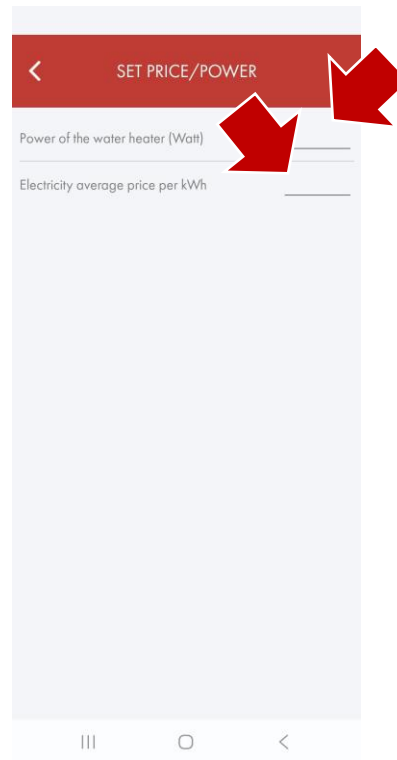

MyThermowatt starts to assess the energy consumption and related cost of your water heater (*)

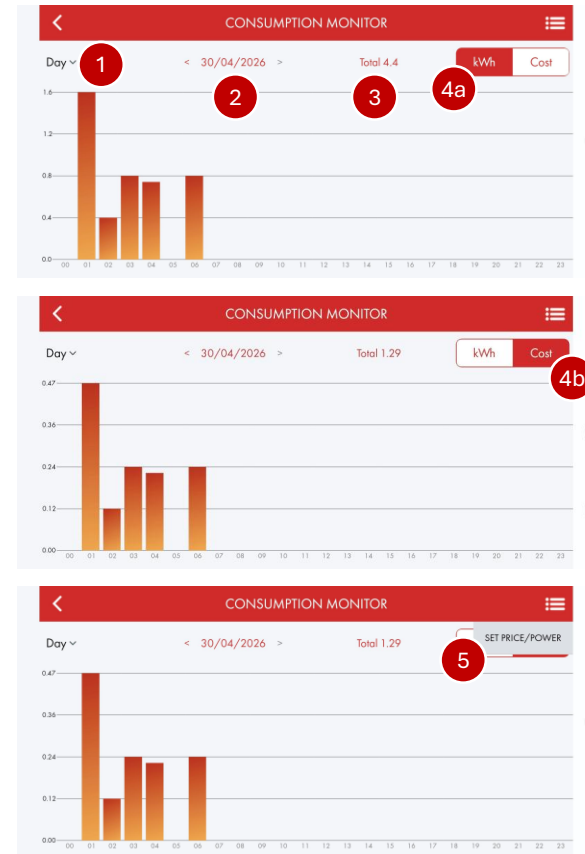

1- TIME: you can select from the dropdown menu the period to monitor (day / month / year)

2- PREVIOUS / CURRENT: you can select with the arrows the current selected period or the previous one

3- TOTAL: the total amount of energy consumption (or cost) for the whole selected period

4- ENERGY CONSUMPTION / COST: you can select to monitor the energy consumption (4a) or the cost (4b)

5- PRICE / POWER: whether you would modify the water heater power and/or the energy price, click on the dropdown menu and click on “SET PRICE/POWER”

(*) Missing Wi-Fi connection or interrupted power supply from the mains could generate incomplete reports



THANKS FOR YOUR ATTENTION!

Visit us at

www.thermowatt.com